

⚠ WARNING

To reduce the risk of drowning, entrapment, falls, paralysis, electrocution, or other serious injury or death:

Dealer/Installer: Give manual to homeowner.

Installer: Read "**Safe Installation**" on page # 2 and all instructions before beginning. For proper assembly and installation, instructions must be followed completely.

Homeowner: Read "**Safe Use**" on back cover before using. Save these instructions.

Installation must comply with local codes and may require permits.

PICKET KIT-SIG-X SYSTEM (PK-SIG-X)

**Fits pools wall height up to 56"
WEIGHT LIMIT 300 LBS.**

ASSEMBLY, INSTALLATION AND USE MANUAL

Assembly video available online: www.conferplastics.com



The Anti-Entrapment Barrier is included in this ladder for the U.S. and Canada only, as required by ANSI/APSP requirements.

The Anti-Entrapment Barrier is NOT intended as a substitute for competent adult supervision.

If you would like to purchase the barrier, please visit our website at: www.conferladders.com



Proudly Made in U.S.A. by

CONFER
plastics inc.

ASSEMBLY INSTRUCTIONS

PICKET KIT MODEL #PK-SIG-X

PARTS LIST	HARDWARE	TOOLS REQUIRED FOR ASSEMBLY
Qty. Description 2 Gate Adapter Post 2 Set of Pickets (single, double, triple)	Qty. Description 42 #10 x 1-1/4" Screw 12 Protective Cap 12 #10 x 3/4" Screw	<ul style="list-style-type: none">• Drill Motor (cordless)• Phillips Bit• Utility Knife

Note: Complete SIG-X System Consists of Step-1X, PES-G-X, 6000X Inpool Ladder and PA-KIT-X Assemble Step-1X and 6000X per their instructions

Note: If Step-1X is completely assembled it will be necessary to remove both handrails.

Safe Installation

⚠ WARNING

To reduce the risk of electrocution, drowning, entrapment, falls, or other serious injury or death:

Check building codes/permitting. Consult your local Building Department before installation of your pool and equipment. Pool/equipment installation must comply with the codes of the authority having jurisdiction and may require permits (e.g., building, plumbing, electrical, zoning, etc.).

Use for intended purpose only

- Use only as a swimming pool ladder.
- This ladder is designed and manufactured for a specific pool wall height and/or deck of the pool - check product specification and the height of your pool.

Check that you have all required parts. Check the contents of the carton with the Parts List for this ladder. All parts and hardware are required. If any parts are missing, **DO NOT attempt to assemble or install the ladder.** Instead, call Toll Free U.S. - 800-635-3213 or visit our web site at www.conferradders.com for assistance.

Select an appropriate location - The ladder must be located on a level, solid base and in a location that will be in full view of competent adult supervision when in use.

Follow all instructions

- For stable, correct assembly and installation, all instructions must be followed completely and in the sequence shown.
- Follow the manufacturer's recommendations for the safe use of all hand tools and equipment used during installation.

Cordless drill only - no corded drills near pool. Use a cordless drill for assembly and installation. To reduce the risk of electrocution, NEVER use a corded drill in or around a pool.

Lift safely. When lifting awkward or heavy loads, have another person help you.

Double check after installation

- Before using the product, after assembly and installation, go over the instructions and procedures again to make sure nothing has been overlooked.
- Make sure that safety labels are installed and legible.

Step 1.

Remove handrails by taking out the four #10 x 1-1/4" screws holding the handrail to the handrail posts and lifting upward.



Step 2.

Slide both gate adapter posts down over the short handrail posts until they bottom out.



Step 3.

Re-install both handrails by inserting the notched ends of handrail into the handrail posts. Fasten the handrails and the gate adapter posts at all of the pre-marked locations using #10 x 1-1/4" screws.



WARNING! Using a corded drill near pool may result in electrocution.

Step 4.



Pickets cut apart

Using a utility knife carefully separate the pickets into one picket, two picket, and three picket assemblies.

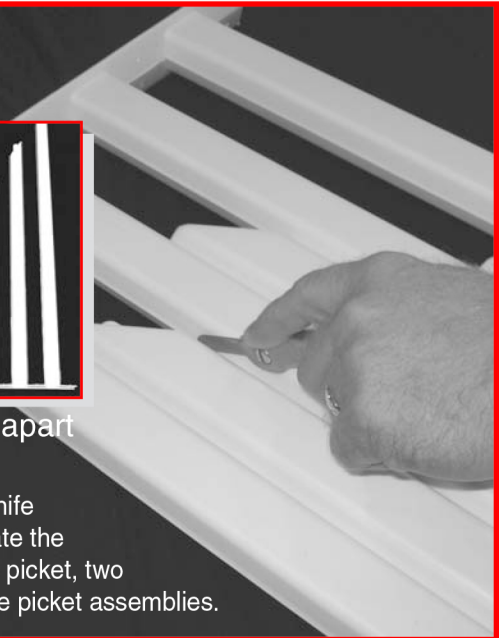

Step 5.



Align one of the triple pickets into the notches of the handrail at the top of the unit. Fasten the pickets in place, at the top of the pickets, using the #10 x 3/4" screws. Continue placing and fastening the double pickets and then the single picket. Repeat for the opposite handrail. Cover the ends of the screws with the protective caps.

Note: the parts for the following steps are found in the gate box with universal gate instructions. Do not use these instructions, follow the instructions below to install gate to Step-1.

Step 6.



Fasten the bottom of the pickets to the step unit at the pre-marked locations using twelve (12) #10 x 1-1/4" screws.

Step 7.



Spread open the flange of the hinge mounting post and slide down over the right gate adapter post (*installed in step #2*) until it comes into contact with side panel.

Step 8.

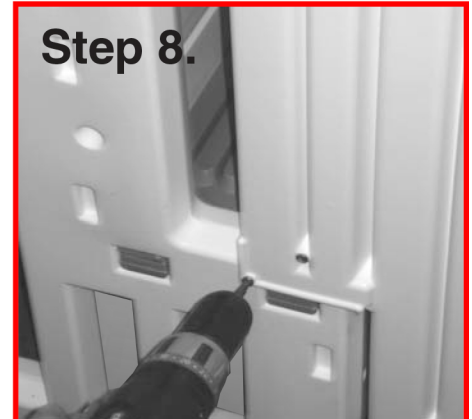

Fasten using eight (8) #10 x 1-1/4" screws at the pre-marked locations on both sides of hinge mounting post.

Step 9.

Spread open the flange of the latch mounting post and slide down over the left gate adapter post (Step 2) until it comes into contact with step side panel. Fasten using eight (8) #10 x 1-1/4" screws at the pre-marked locations on both sides of the latch mounting post.



Step 10.

Slide the open gate hinge through the hinge posts pin opening and wrap the gate hinge around the hinge pin. Fasten the hinge at all four pre-marked spots using the #7 x 1/2" self tapping screws. (4 per hinge)



Step 11.

Install the latch to the upper mounting block of the latch mounting post using four (4) #10 x 1-1/4" self tapping screws.



Step 12.

With the gate closed align the bar/plate by locking round end into the latch and holding flat end with two holes level on the gate. Fasten using two (2) #10 x 1-1/4" self tapping screws.



Step 13.

Install the gate closer in the indented portion provided on the hinge post. Follow the directions provided with the gate closer package, but **OMIT Step. #4**. The slide plate is for metal/wood and will not work with gravity hinge on gate.



ADJUST THE TENSION ON CLOSER (See details provided on closer Package) SO THE GATE WILL SELF CLOSE AND LATCH EVERY TIME. CLOSE THE GATE SEVERAL TIMES AND MAKE ADJUSTMENTS IF NECESSARY.

Step 14.

Place completed step on outside of pool where you want to enter and exit pool, step must be on level solid surface. Install completed inpool ladder per ladder instructions making sure the bottom tread rests on pool bottom. Extend the tubes/mounting blocks down until they rest on top tread of Step-1. After ladder is in position fasten mounting blocks to top tread on Step-1 using eight (8) #10 x 1-1/4" screws.



Safe Use

⚠ WARNING

To reduce the risk of drowning, entrapment, falls, paralysis, or other serious injury or death:

Use ladder properly.

- **No diving or jumping from ladder** - shallow water; risk of paralysis or death.
- FOR ENTRY/EXIT OF POOL, FACE THE LADDER AT ALL TIMES.
- ONE PERSON ON THE LADDER/STAIR AT A TIME.
- To reduce the risk of entrapment or drowning, DO NOT swim through, behind or around ladder.
- Illuminate the ladder when using the pool at night.

Weight limit - 300 lbs maximum. Exceeding maximum weight may cause the ladder to fail.

Secure ladder when not in use.

Watch children at all times when they are in or around water to help prevent drowning.

BE SURE AND SAFE. The manufacturer **IS NOT** responsible for improper assembly Installation and use.

WINTERIZING: Unfasten the ladder from adjustable tubes and remove from the water. Lay the ladder on its side to drain. It will take several minutes for the water to drain out of the ladder rails and treads. A Small amount of water left in ladder will not cause any damage. To reinstall, see Step #14.

CONFER PLASTICS INC. FIVE YEAR WARRANTY

Confer Plastics Inc. warrants their swimming pool ladders and steps to be free from defects in workmanship for five years from date of purchase.

DO NOT RETURN DEFECTIVE PART TO DEALER

E-MAIL CONFER PLASTICS AT: **LADDERS@CONFERPLASTICS.COM**
A PICTURE [S] OF DEFECTIVE PART, A BRIEF DESCRIPTION OF PROBLEM,
PROOF OF PURCHASE AND YOUR CONTACT INFORMATION.

INFORMATION MAY ALSO BE FAXED TO CONFER PLASTICS AT: **716-694-3102**
OR MAILED TO THE ADDRESS BELOW. UPON REVIEW OF THE INFORMATION YOU
WILL BE NOTIFIED IF PART IS COVERED UNDER THE WARRANTY AND
THE SHIPPING/HANDLING CHARGES.

This warranty gives you specific legal rights, and you may also have other rights which may vary from state to state.

Confer Plastics Inc., 97 Witmer Road, North Tonawanda, N.Y. 14120-2421

MADE IN THE USA



CONFER
plastics inc.

Printed in USA

97 Witmer Road
North Tonawanda, New York 14120-2421
Toll Free U.S. 800-635-3213
FAX 716-694-3102
www.conferladders.com